

EDITION OF NOV. 8, 1916.
REVISIONS: MAR. 21, 1919.

SERIAL NUMBER

124

CONFIDENTIAL.

ENTRANCE TO CHESAPEAKE BAY

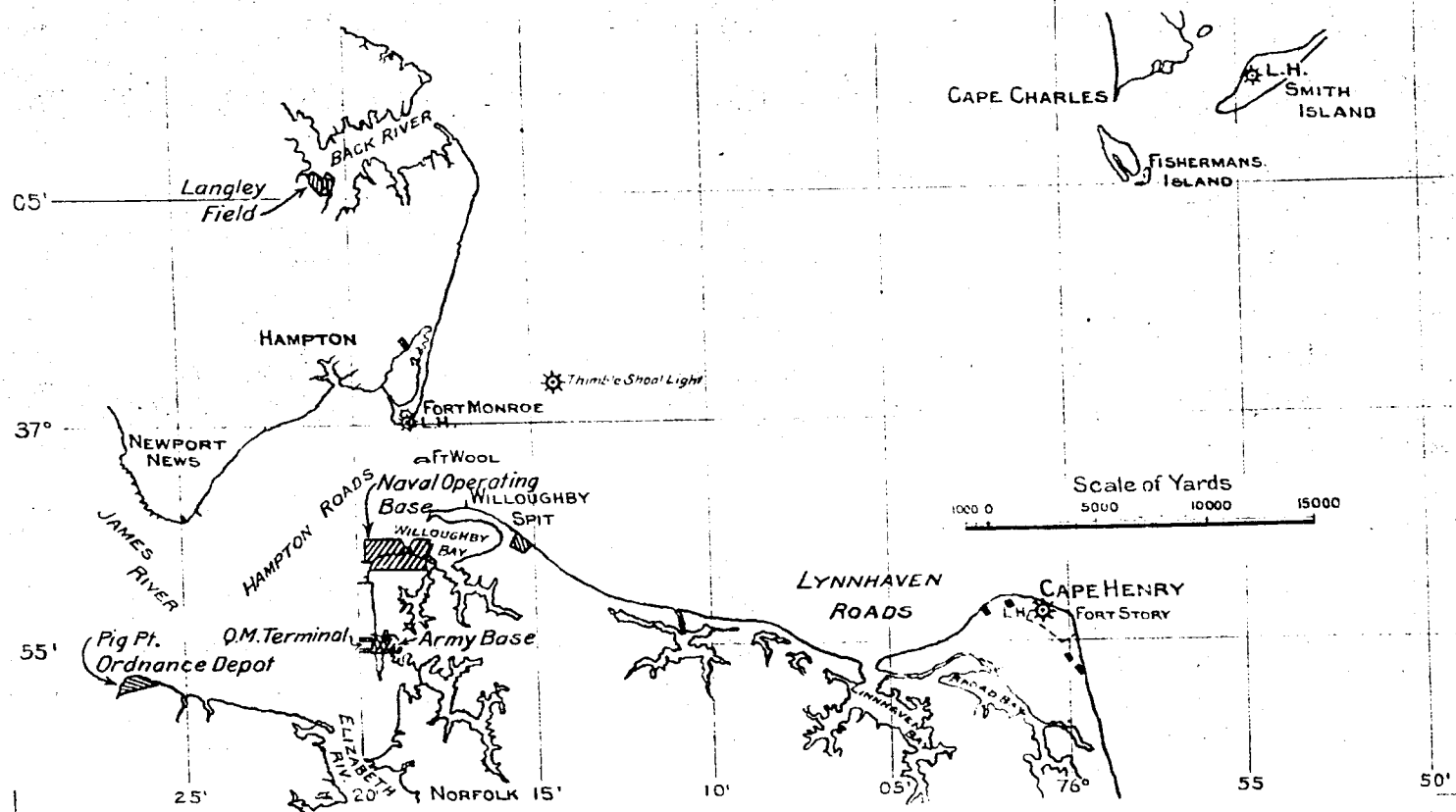

EDITION OF JAN. 14, 1915.
 REVISIONS, NOV. 8, 1916.
 MAR. 21, 1919, JAN. 1, 1921.

SERIAL NUMBER

124

CONFIDENTIAL

ENTRANCE TO CHESAPEAKE BAY

FORT STORY

GENERAL MAP

1000 0 3000 5000 Ft.

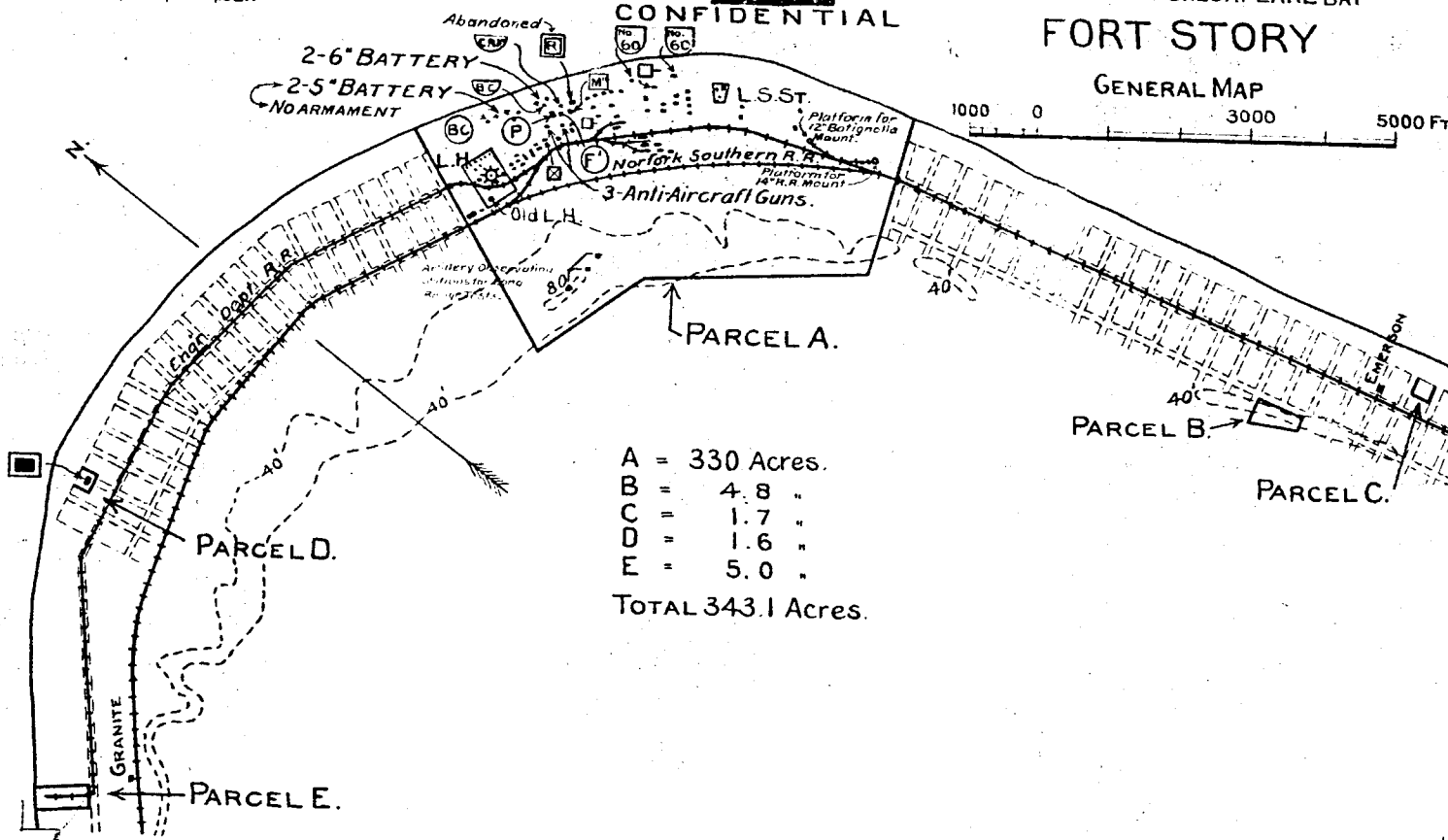

A = 330 Acres.
 B = 4.8 "
 C = 1.7 "
 D = 1.6 "
 E = 5.0 "
 TOTAL 343.1 Acres.

LEGEND

1. ADMINISTRATION BLDG.
2. COMM. OFFICERS QRS.
3. OFFICERS QRS.
4. HOSPITAL.
6. N.G. OFFICERS QRS.
7. BARRACKS.
8. GUARD HOUSE.
9. POST EXCHANGE.
10. MESS.
11. POST BUILDING.
- 12.
13. OIL HOUSE.
20. Q.M. QUARTERS.
21. Q.M. WATER TOWER.
22. Q.M. STABLE.
23. Q.M. FIRE HOSE HOUSE.
24. Q.M. STORE HOUSE.
25. Q.M. LAVATORY.
26. Q.M. BATH.
27. Q.M. COMMISSARY.
28. Q.M. CARPENTER SHOP.
29. Q.M. COAL BIN.
30. ORDNANCE QRS.
40. E.D. OFFICE.
41. E.D. CEMENT HOUSE.
42. E.D. SHOP.
43. E.D. & Q.M. WATER TOWER.
44. E.D. BOILER ROOM.
45. E.D. LOCOMOTIVE HO.
46. E.D. LUMBER SHED.
47. E.D. COAL BIN.
48. E.D. QUARTERS.
49. E.D. OIL HOUSE.
- 49a. E.D. FIRE HOSE HOUSE.
100. E.D. MESS.
101. E.D. STORE HOUSE.
70. SERVICE CLUB.
90. N.&S.R.R. PASS. SHED.
91. N.&S.R.R. FREIGHT PLAT.
92. N.&S.R.R. DEPOT AT CAPE HENRY.

EDITION OF JAN. 1, 1921.
REVISIONS JUNE 9, 1922.

SERIAL NUMBER

124

CONFIDENTIAL

ENTRANCE TO CHESAPEAKE BAY

FORT STORY D-1.

PARCEL "A"

BATTERIES

PENNINGTON... 4-16" H.

A-Anti-Aircraft gun 3-3"

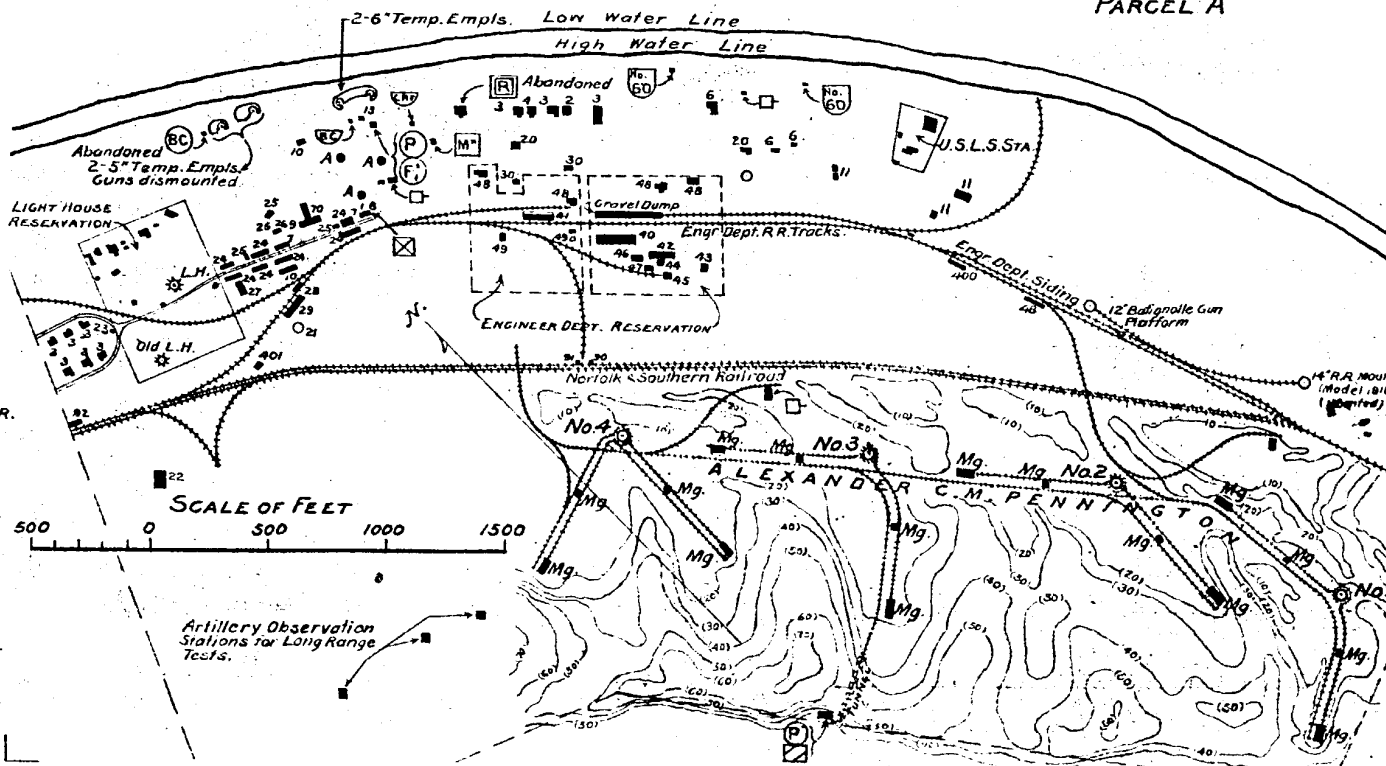

EDITION OF JAN. 4, 1915.
REVISIONS: JUNE 9, 1916.

SERIAL NUMBER **124**
CONFIDENTIAL

HAMPTON ROADS, VA.

STATUTE MILES.
0 1/2 1 2

THE PLANE OF REFERENCE IS MEAN LOW WATER.

Mean Rise and fall of Tides 2.56

Max. draft of Vessels about 30 ft.

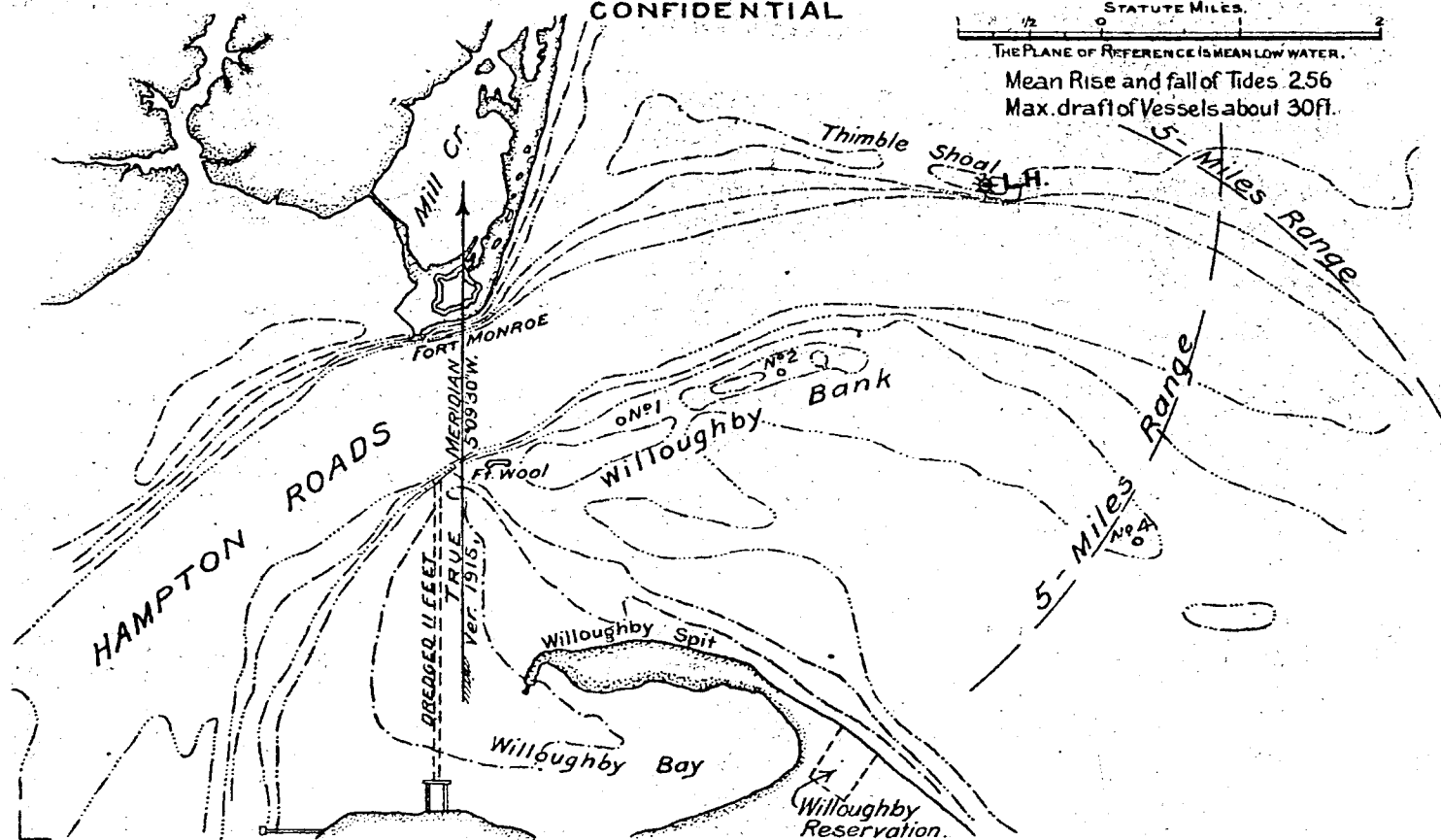

LEGEND
 7. BARRACKS.
 10. MESS HALL.
 11. COAL SHED.
 12. BATH HOUSE.

EDITION OF JUNE 9, 1916.
 REVISIONS: APR. 1, 1921.

SERIAL NUMBER

124

CONFIDENTIAL.

HAMPTON ROADS, VA.

FORT WOOL

BATTERIES.

* CLAIBORNE... 2-6" D.
 * DYER... 2-6" D.
 GATES... 2-6" D.
 LEE... 4-3" P.
 HINDMAN... 2-3" P.
 * Guns Dismounted.

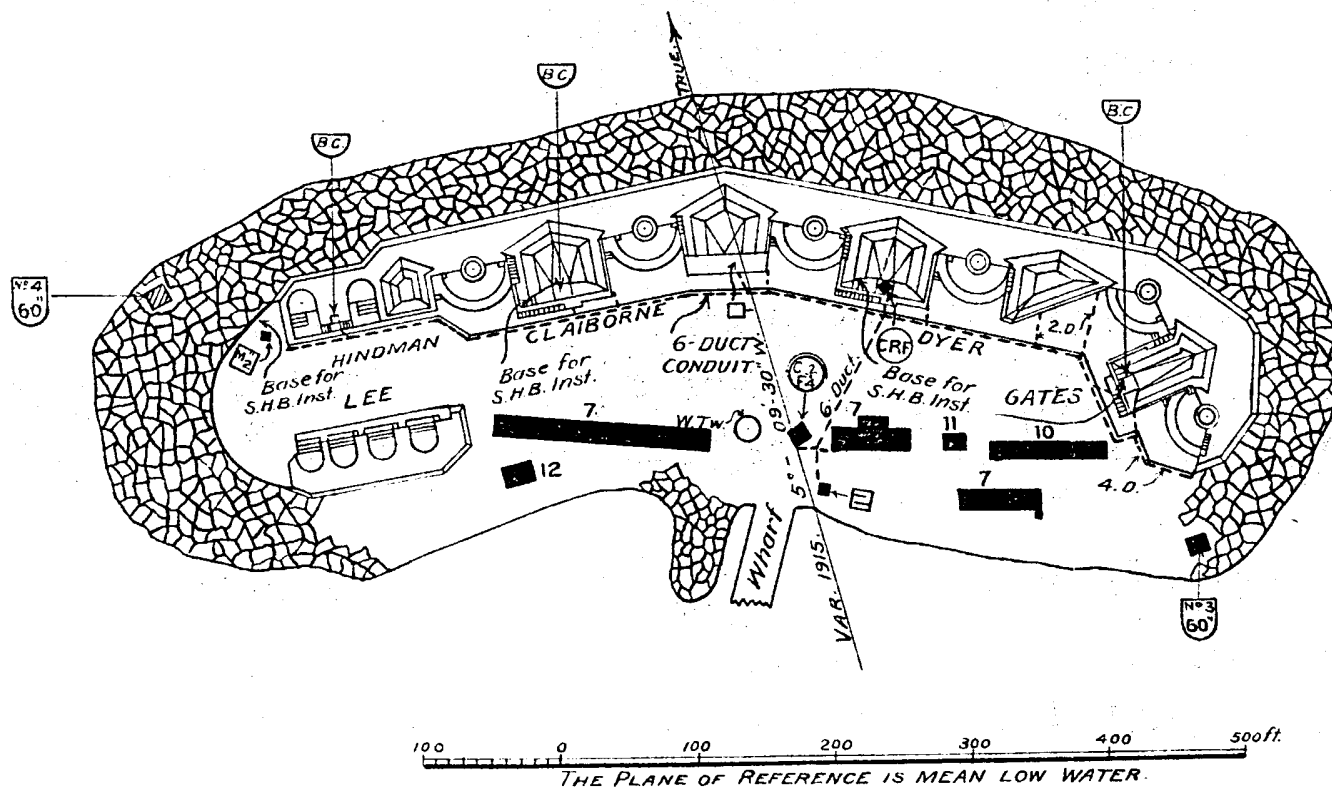

EDITION OF JUNE 9, 1916.
REVISIONS: APR. 1, 1921.

SERIAL NUMBER

124

CONFIDENTIAL.

HAMPTON ROADS, VA.

FORT MONROE

OLD POINT COMFORT.
GENERAL MAP.

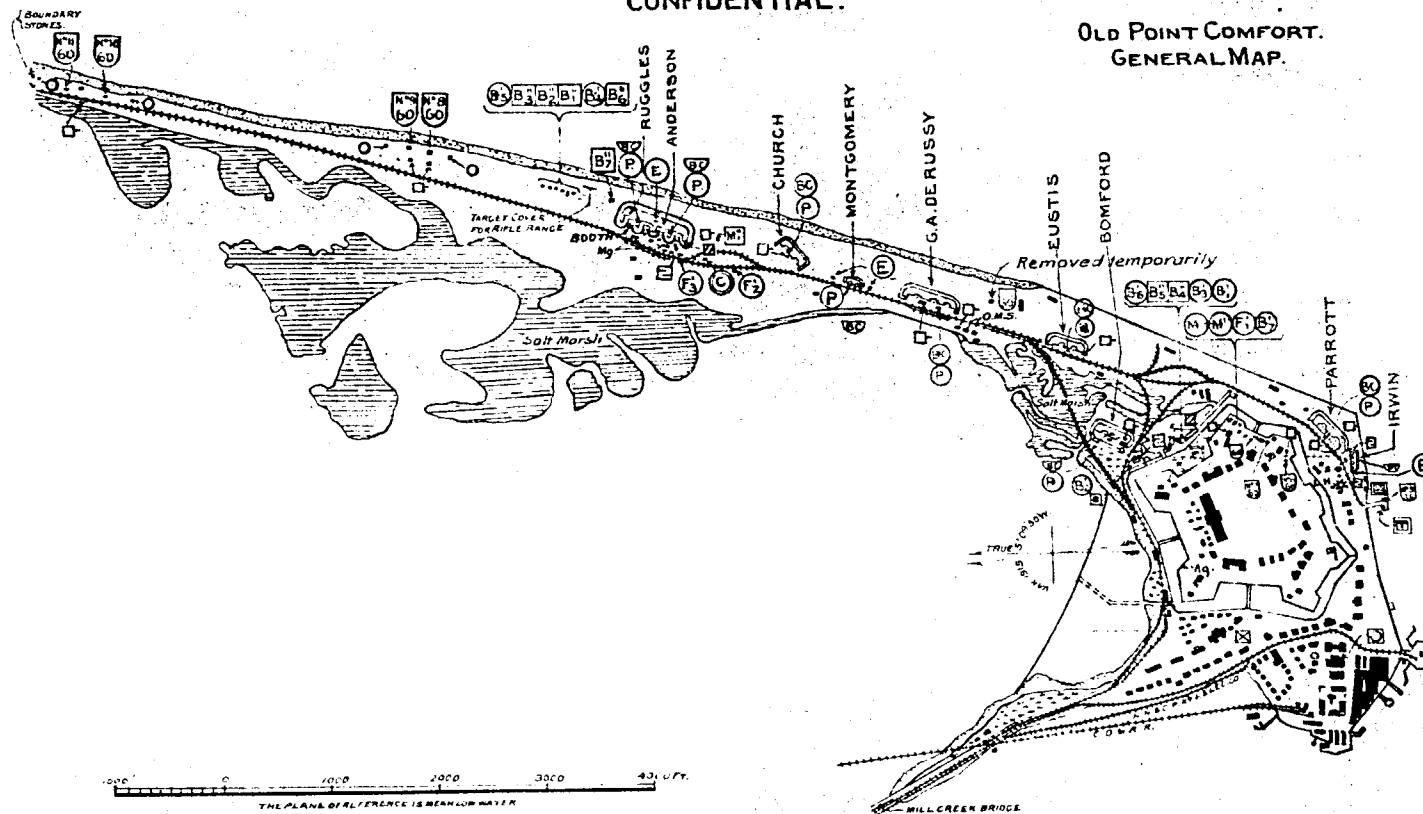

LEGEND

- 1 ADMINISTRATION BLDG.
- 2 COMMANDING OFF. QRS.
- 3 OFFICER'S QRS.
- 3a WARRANT OFF. QRS.
- 4 HOSPITAL.
- 4a CONTAGIOUS HOSPITAL.
- 5 HOSPITAL STWD'S QRS.
- 6 N.C.O. QUARTERS.
- 7 BARRACKS.
- 8 GUARD HOUSE.
- 9 POST EXCHANGE.
- 10 ARTILLERY SCHOOL.
- 11 TRAINING CENTER HORS.
- 12 C.A.S. CLASSROOM.
- 13 BOILER HOUSE.
- 14 STOREHOUSE.
- 15 PRINTING HOUSE.
- 16 C.A.S. ASSEMBLY ROOM.
- 17 SEWAGE TANK & P. HO.
- 18 GARAGE LABORATORY.
- 19 SHERWOOD INN - OFFICERS QUARTERS.
- 100 GARAGE.
- 101 TOOL AND OIL ROOM.
- 102 MOTORCYCLE GARAGE.
- 103 S.L. LABORATORY.
- 104 PIER.
- 105 POST LAUNCH HOUSE.
- 106 ENL. MENS BATH HO.
- 107 HEATING PLANT.
- 108 C.A.S. PHOTO. LAB'TY.
- 109 LAVATORY.
- 110 MESS KITCHEN.
- 111 BAND MESS.
- 112 GYMNASIUM.
- 113 TESTING ROOM.
- 114 SALVAGE ST. HO.
- 115 LAUNDRY.
- 116 GALVANOMETER HO.
- 117 VOCATIONAL TRAINING CLASS ROOM.
- 118 POST SCHOOL.
- 119 CASEMATES.
- 120 OFFICERS LIBRARY.

EDITION OF JAN. 1, 1921.
REVISIONS: APR. 1, 1921.

SERIAL NUMBER

124

CONFIDENTIAL

CHESAPEAKE BAY FORT MONROE D-1.

SCALE OF FEET

100 200 0 400 800

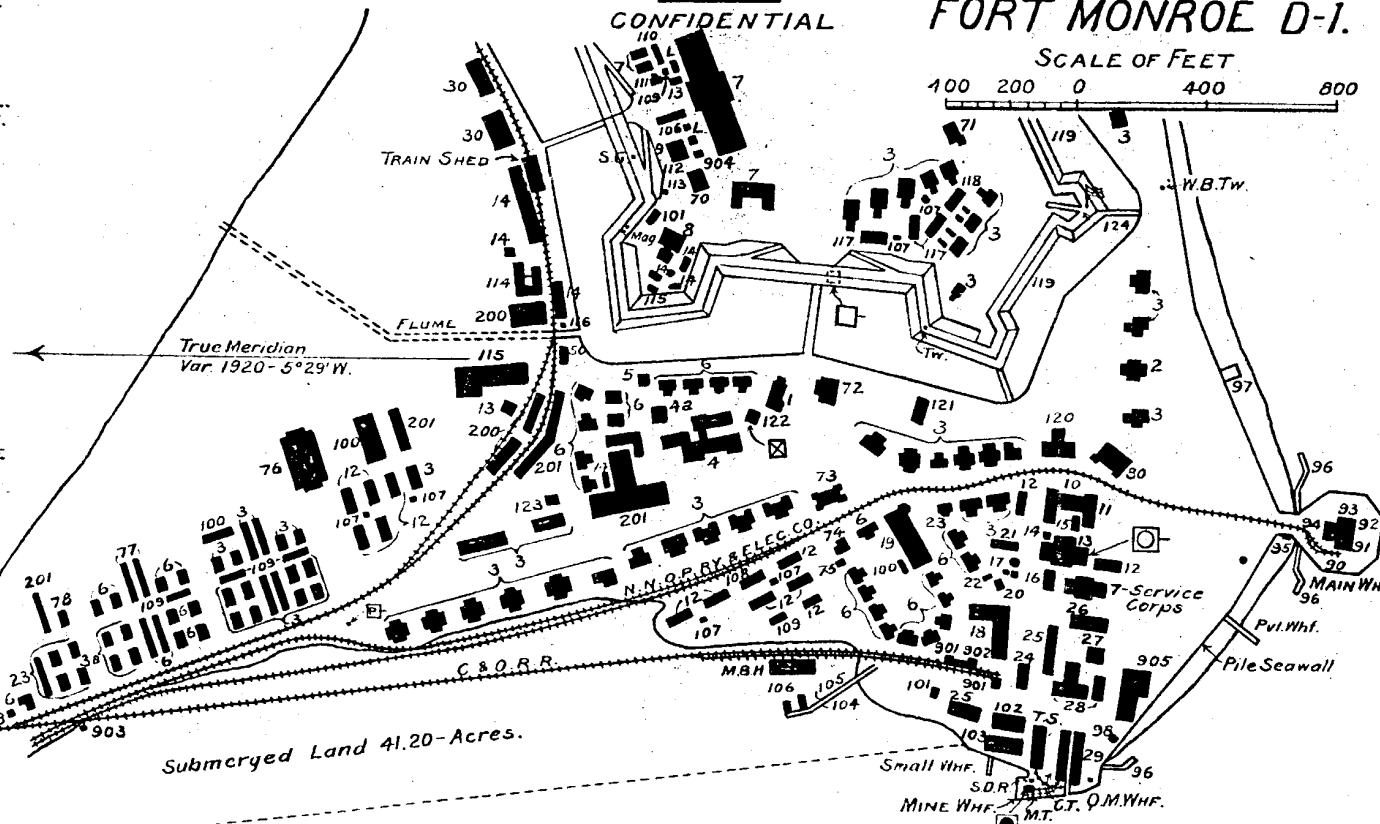

- 121 C.A.S. PHOTO. ENG. LAB'TY.
- 122 FIRE ENGINE HO. TEL. EXG. 66
- 123 NURSES QRS.
- 124 OFFICER'S CLUB.
- 20 Q.M. OFFICE.
- 21 CONSTG. Q.M. & FIN. OFFICE.
- 22 Q.M. SUPPLY OFFICE.
- 23 Q.M. EMPLOYEE.
- 24 OFFICE & TEAMSTERS QRS.
- 25 Q.M. WAGON SHED.
- 26 M.C.T. OFFICE, ST. ROOM, AND BLACKSMITH SHOP.
- 27 Q.M. GARAGE.
- 28 Q.M. STABLE.
- 29 Q.M. STOREHOUSE & BOAT SUPPLIES.
- 200 Q.M. SHOPS.
- 201 Q.M. STOREHOUSE.
- 30 ORDNANCE ST. HO.
- 50 SIGNAL CORPS ST. HO.
- 70 ENL. MENS LIBRARY.
- 71 CHAPEL.
- 72 Y.M.C.A. BUILDING.
- 73 CATHOLIC CHURCH.
- 74 PRIESTS HOUSE.
- 75 CATHOLIC CLUB.
- 76 LIBERTY THEATRE.
- 77 HOSTESS HOUSE.
- 78 HOSTESS HO. DORMITORY.
- 80 POST OFFICE.
- 90 AMERICAN RAILWAY EXPRESS.
- 91 BAGGAGE ROOM.
- 92 FREIGHT HOUSE.
- 93 STEAMBOAT TICKET OFF.
- 94 WAITING ROOM.
- 95 BOOK STORE & CAFE.
- 96 LANDING FOR SMALL BOATS.
- 97 PAVILION.
- 98 CHAMBERLIN GARAGE.
- 901 C. & O. FREIGHT HOUSE.
- 902 C. & O. DEPOT.
- 903 N.N. & O.P.R.Y. WATCH HO.
- 904 CAFE.
- 905 CHAMBERLIN BOILER HOUSE & LAUNDRY.

LEGEND

3 OFFICER'S QRS.
6 N.C.O. QUARTERS.
6a ENLISTED MENS QRS.
7 BARRACKS.
13 BOILER HOUSE.
14 STORE HOUSE.
101 TOOL AND OIL HOUSE 14
106 ENCL. MENS BATH HO.
109 LAVATORY.
110 MESS KITCHEN.
111 BAND MESS.
125 ARTILLERY SCHOOL.
RADIO STATION.
126 BOARD WALK.
127 GUN SHED.
128 OFFICER'S BATH HO.
129 ARTILLERY ENGRS. ST. HO.
130 SUBSTATION.
131 QUARTERS METEORO-
LOGICAL SQUAD.
132 VOCATIONAL TRAIN-
ING OFFICE.
133 " "
134 BAKERY.
201 Q.M. STOREHOUSE.
202 COMMISSARY ST. HO.
300 ORDNANCE ST. HO.
40 ENGR. DEPT. OFFICE.
41 " " ST. HO.
42 " " QUARTERS.
43 " " SHOPS.
71 CHAPEL.
99 LIEUT. ELDRIDGE.
900 DOCTOR, U.S.
QUARANTINE SERVICE.

EDITION OF JAN. 1, 1921.
REVISIONS: APR. 1, 1921.

SERIAL NUMBER

CONFIDENTIAL

124

CHESAPEAKE BAY FORT MONROE D-2.

SCALE OF FEET

400 200 0 400 800

True Meridian
Var 1920 - 5° 29' W.

BATTERIES.
PARROTT.....2-12" D.
BOMFORD.....2-10" D.
EUSTIS.....2-10" D.
+ BARBER.....1-8" N.D.
+ IRWIN.....4-3" B.P.
+ OUT OF COMMISSION.

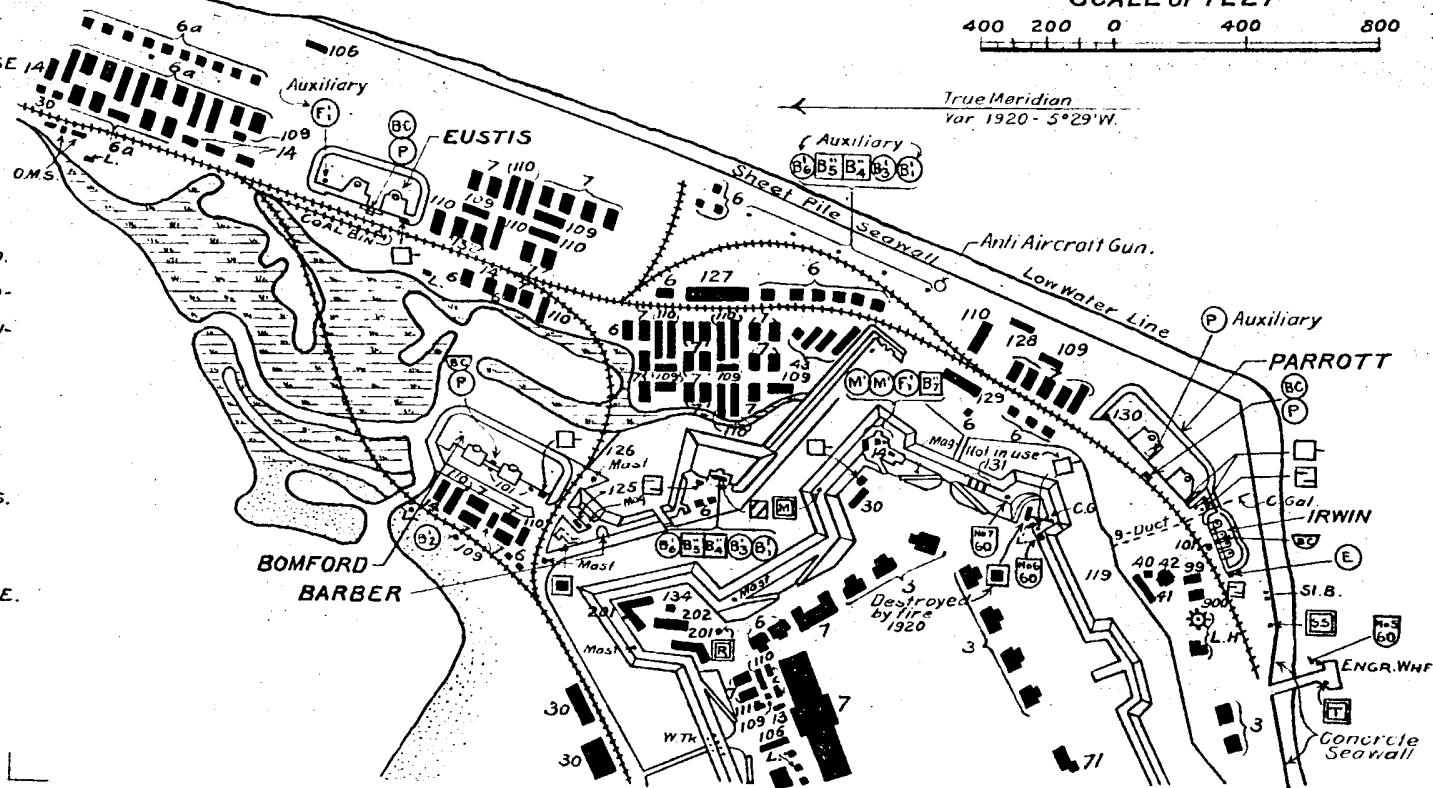

LEGEND

6 N.G.O. QUARTERS.
7 BARRACKS.
8 GUARD HOUSE.
14 STORE HOUSE.
30 ORDNANCE ST. HO.
100 GARAGE.
101 TOOL & OIL ROOM.
109 LAVATORY.
110 MESS KITCHEN.
135 TRACTOR SHED.
136 CAMP KITCHEN.
137 TARGET COVER AND RIFLE RANGE.

EDITION OF JAN. 1, 1921.

SERIAL NUMBER

124

CONFIDENTIAL

CHESAPEAKE BAY FORT MONROE D-3.

SCALE OF FEET

400 200 0 400 800

BATTERIES.

RUGGLES.....4-12"M.
ANDERSON.....4-12"M.
DE RUSSY.....3-12"D.
CHURCH.....2-10"D.
MONTGOMERY.....2-6"N.D.

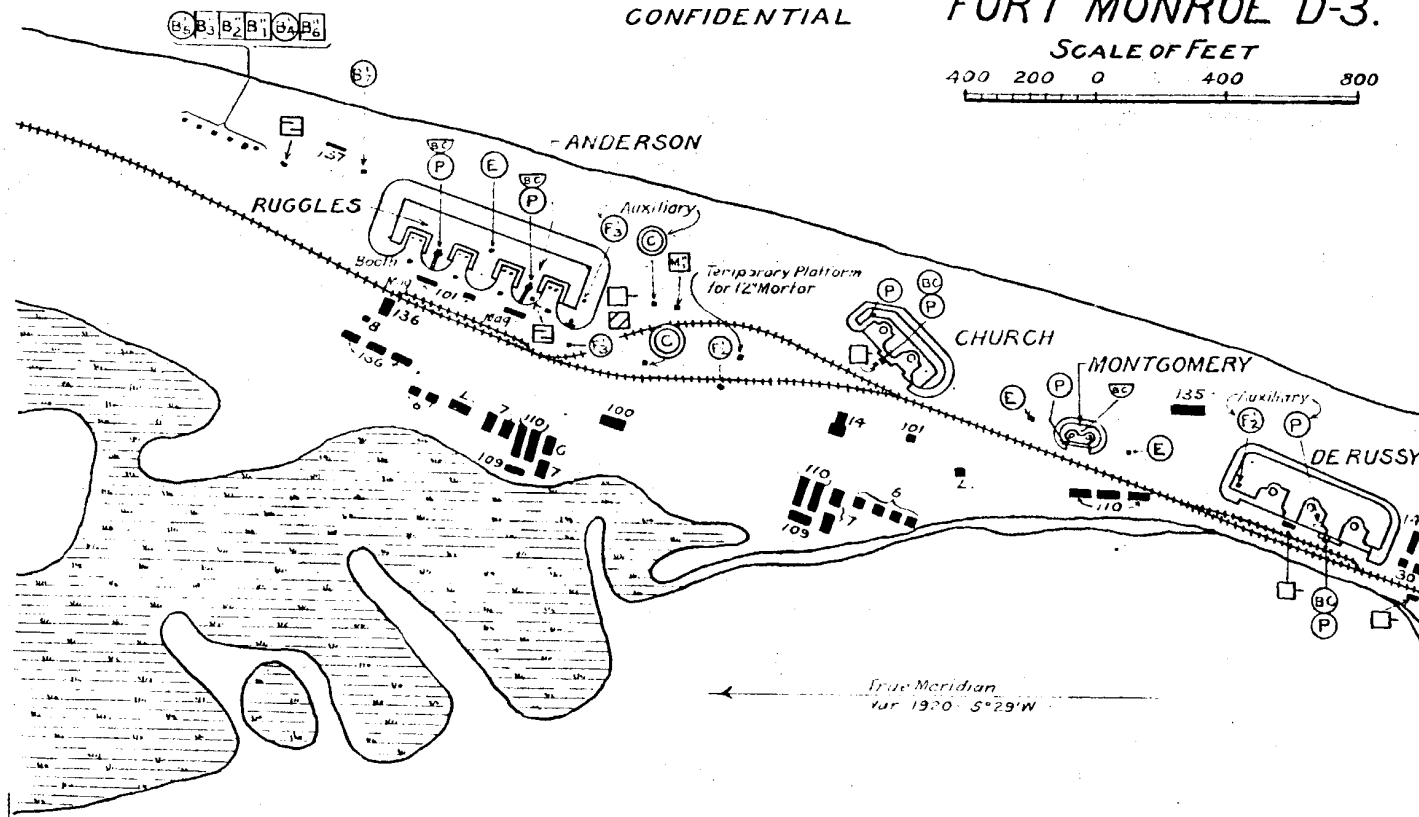

LEGEND
 8 GUARD HOUSE.
 14 STORE HOUSE.
 138 BALLOON HANGAR.

EDITION OF JAN. 1, 1921.

SERIAL NUMBER

124

CONFIDENTIAL

CHESAPEAKE BAY
FORT MONROE D-4.

SCALE OF FEET

400 200 0 400 800

