



POTOMAC RIVER  
**FORT WASHINGTON**

SERIAL NUMBER **124**  
 CONFIDENTIAL

EDITION OF MAY 5, 1919.  
 REVISIONS: FEB. 28, 1920;  
 JUNE 1, 1921.

MARYLAND  
 GENERAL MAP.  
 Scale of feet.  
 0 1000

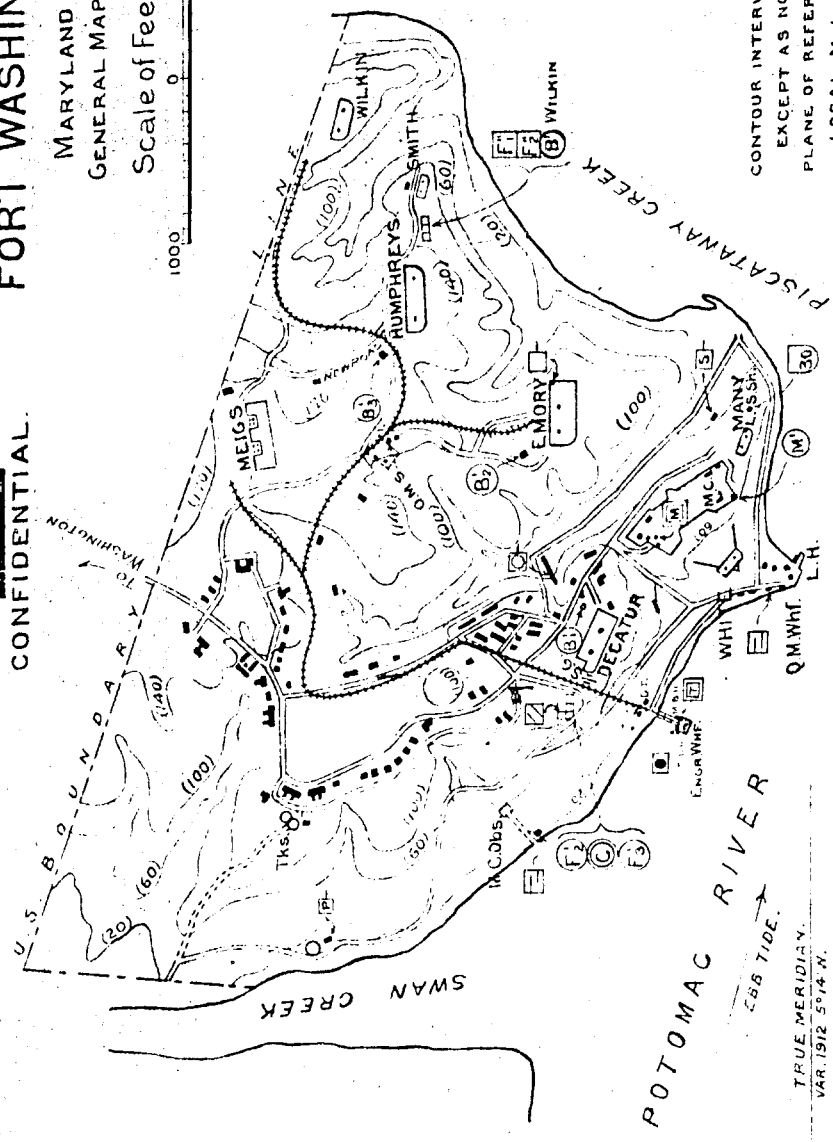

**BATTERIES.**

*MEIGS	8	12" M.
*DECATUR	1	10" Dis
*EMORY	2	10" "
HUMPHREYS	2	6" "
WILKIN	2	4" P.
*WHITE	2	3" B.F.
SMITH	2	3" P.
MANY	2	3" P.

\* Empl. No / vacant  
 \* Abandoned.

CONTOUR INTERVAL - 40 FT.  
 EXCEPT AS NOTED.  
 PLANE OF REFERENCE -  
 LOCAL M.L.W.

TRUE MERIDIAN.  
 VAR. 1912 5° 14' N.



EDITION OF MAY 5, 1913.  
 REVISIONS: JUN. 25, 1920.  
 JUNE 1, 1921.

**LEGEND**

- 2 COMMANDING OFFQRS.
- 3 OFFICERS QRS.
- 4 HOSPITAL.
- 5 HOSPITAL STWD'S QRS.
- 6 NCO QUARTERS.
- 7 BARRACKS.
- 7a ENLISTED MEN'S QRS.
- 8 GUARD HOUSE.
- 9a SENTRY BOX.
- 9 POST EXCHANGE.
- 11 GYMNASIUM.
- 12 MESS HALL.
- 13 ENGINE HOUSE.
- 14 GARAGE.
- 15 FIRE APPARATUS.
- 16 BAKERY.
- 19 BOWLING ALLEY.
- 100 COAL SHED.
- 101 POST OFFICE.
- 102 STORE HOUSE.
- 105 BLACKSMITH, CARPENTER & PLUMBER SHOP.
- 107 LOCOMOTIVE HOUSE.
- 108 SAW MILL.
- 109 OIL HOUSE.
- 110 TOOL HOUSE.
- 111 SCALES.
- 112 GOAT HOUSE.
- 120 FIELD HEADQUARTERS.
- 21 Q.M. SHOPS.
- 22 Q.M. & C. STORE HOUSE.
- 23 Q.M. STABLES.
- 24 Q.M. BOAT HOUSE.
- 31 ORDNANCE ST. HO.
- 40 ENGINEER OFFICE.
- 41 ENGINEER ST. HO.

SERIAL NUMBER **1214**

CONFIDENTIAL. FORT WASHINGTON D-2.

POTOMAC RIVER MARYLAND.

Scale of feet  
 100 0 500 1000

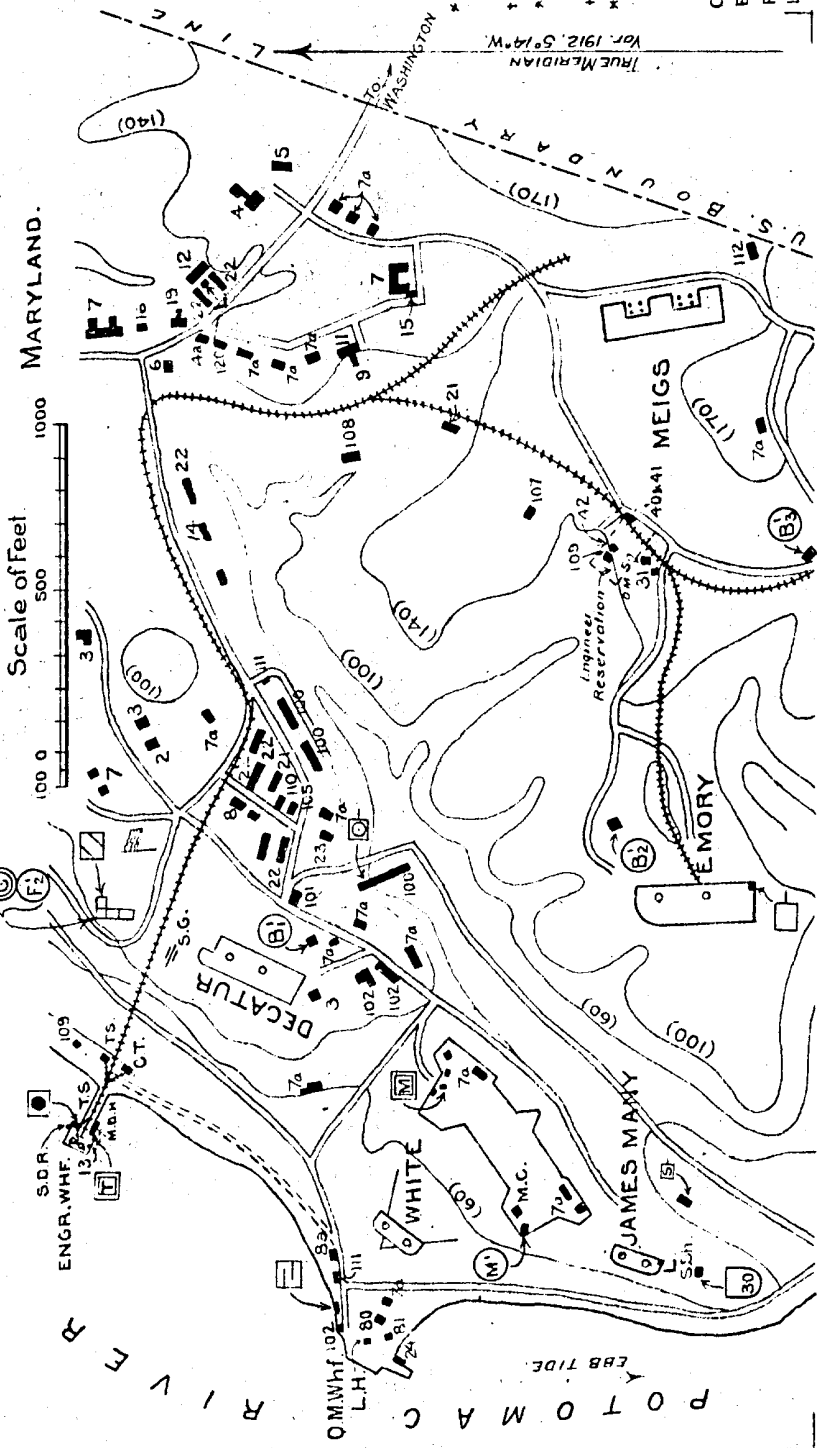

**BATTERIES.**

\*MEIGS..... 8-12" M.  
 \*DECATUR.....  
 \*EMORY..... 1-10" Dis  
 \*WHITE..... 2-4" P.  
 \*MANY..... 2-3" P.  
 † Empl. Not vacant.  
 \* Abandoned.

CONTOUR INTERVAL-40 FT  
 EXCEPT AS NOTED.  
 PLANE OF REFERENCE-  
 LOCAL M.L.W.

42 ENGINEER SHOP.  
 80 LIGHT KEEPER'S HO.  
 81 L.H. PAINT HOUSE.

True Meridian  
 Var. 1912. 5° 14' W

**LEGEND.**

7a. ENLISTED MEN'S QRS.

109 OIL HOUSE.

112 GOAT HOUSE.

EDITION OF MAY 5, 1919.  
REVISIONS: FEB. 28, 1920.  
JUN. 25, 1920.

SERIAL NUMBER

**1274**

POTOMAC RIVER

**CONFIDENTIAL. FORT WASHINGTON D-3.**

BATTERIES.

HUMPHREYS 2-10" Dis.

WILKIN 2-6" "

SMITH 2-3" B.P.

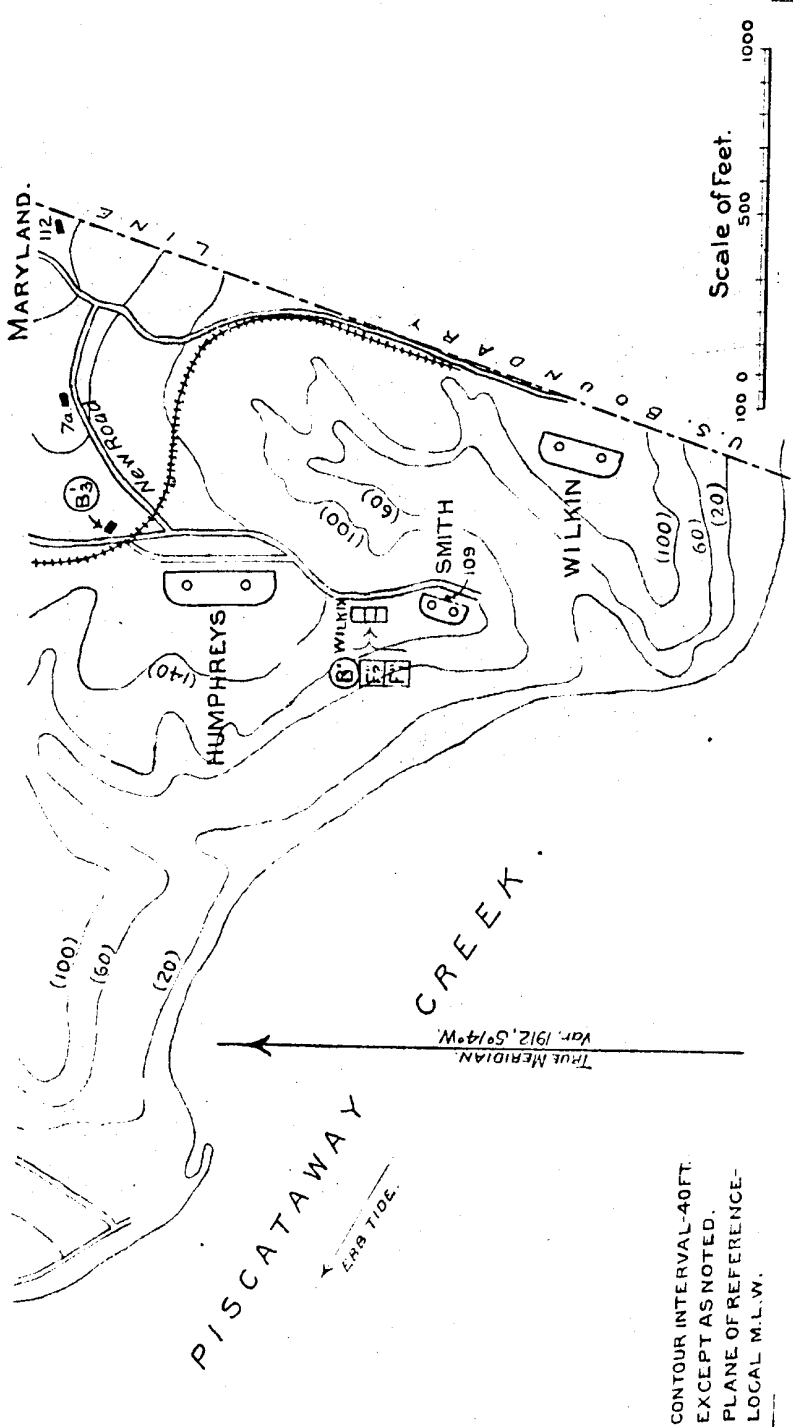

CONTOUR INTERVAL-40 FT.  
EXCEPT AS NOTED.  
PLANE OF REFERENCE-  
LOCAL M.L.W.

Scale of Feet.

EDITION OF MAY 5, 1919.  
REVISIONS: JUN. 25, 1920;  
JUNE 1, 1921.

SERIAL NUMBER **124**  
CONFIDENTIAL.

POTOMAC RIVER BATTERIES  
FORT HUNT  
SHERIDAN POINT, VA.  
GENERAL MAP.

MT. VERNON  
PORTER  
ROBINSON  
SATER

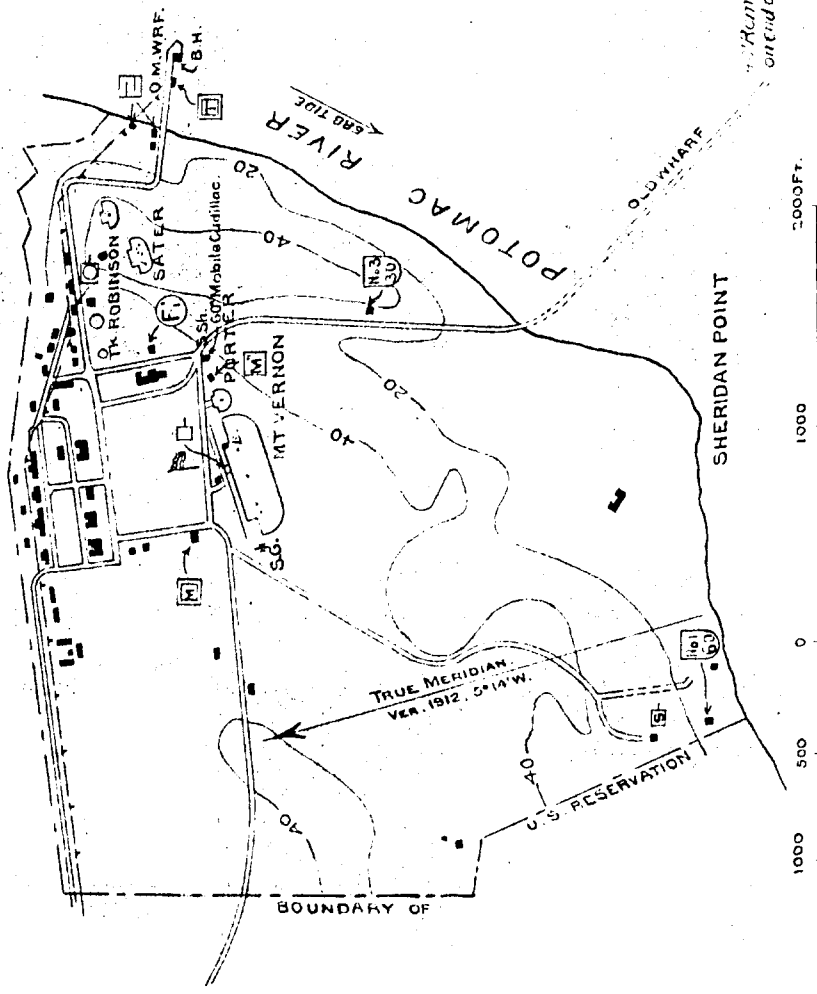

CONTOUR INTERVAL - 20 FT.  
PLANE OF REFERENCE - SAME  
AS HARBOR CHART. LOCAL M.L.W.  
Removed Light maintained  
outside of harbor.

POTOMAC RIVER  
**FORT HUNT D-I.**  
 SHERIDAN POINT, VA.  
 BATTERIES  
 MT.VERNON  
 PORTER  
 ROBINSON  
 SATER

SERIAL NUMBER **124**  
 CONFIDENTIAL

EDITION OF MAY 5, 1919.  
 REVISIONS: JUN. 25, 1920;  
 JUNE 1, 1921.

**LEGEND**

- 1 ADMINISTRATION BLDG.
- 2 COMMANDING OFF.ORS.
- 3 OFFICER'S ORS.
- 4 HOSPITAL.
- 5 HOSPITAL STWD'S ORS.
- 6 N.C.OFFICER'S ORS.
- 7 BARRACKS.
- 8 GUARD HOUSE.
- 9 POST EXCHANGE.
- 10 MESS HALL.
- 11 LAVATORY.
- 12 BAKERY.
- 13 OIL HOUSE.
- 14 COAL SHED.
- 15 WAGON SHED.
- 16 TOOL HOUSE.
- 17 SAW MILL.
- 19 STORE HOUSE.
- 100 SCALES.
- 101
- 102 PLUMBER'S SHOP
- 103 CARPENTER'S SHOP & TEAMSTERS ORS.
- 104 ENLISTED MENS ORS.
- 105 RESERVOIR.
- 106 FIRE APPARATUS.
- 21 Q.M.'S STORE HOUSE.
- 22 Q.M.'S STORE HOUSE.
- 23 Q.M.'S STABLE.
- 31 ORDNANCE ST.HO.
- 4 ENGINEER ST. HO.

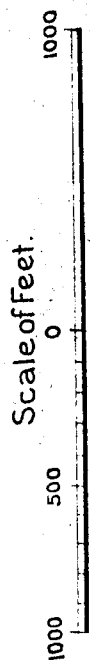

CONTOUR INTERVAL - 20 FT.  
 PLANE OF REFERENCE - SAME  
 AS HARBOR CHART - LOCAL M.L.W.

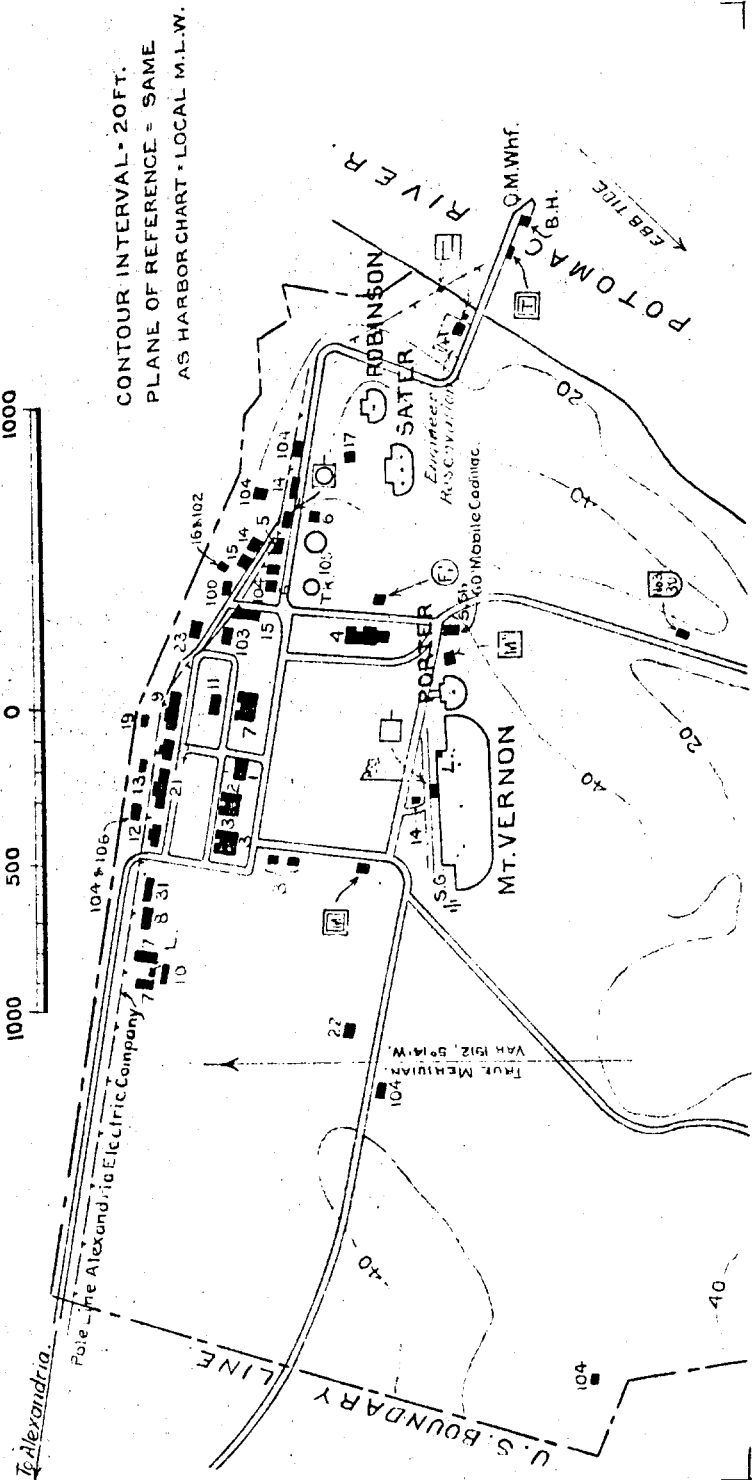

POTOMAC RIVER  
**FORT HUNT D-2.**  
 SHERIDAN POINT, VA.

SERIAL NUMBER **124**  
 CONFIDENTIAL

EDITION OF MAY 5, 1919.  
 REVISIONS, JUNE 1, 1921.

**LEGEND**  
 18 RIFLE BUTT.  
 101 INCINERATOR

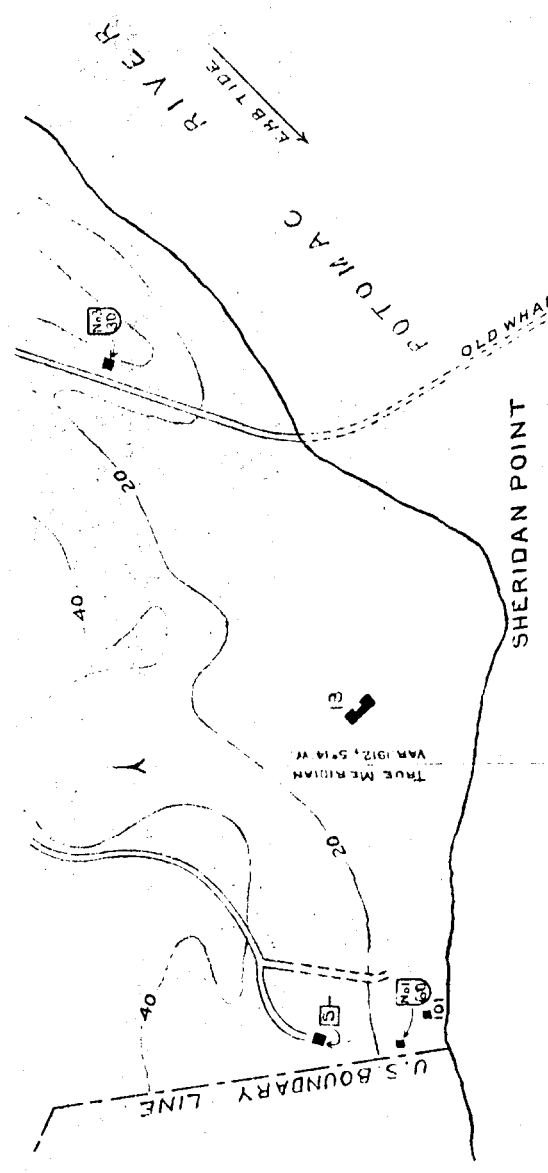

CONTOUR INTERVAL = 20 FT.  
 PLANE OF REFERENCE = SAME  
 AS HARBOR CHART = LOCAL M.L.W.  
 40 - Removed Light maintained  
 on end of Wharf.

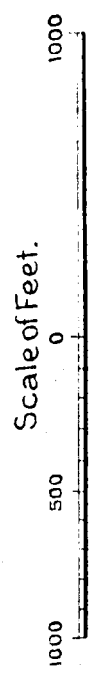



EDITION OF: MAR. 14 1916.

SERIAL NUMBER

124

# WASHINGTON BARRACKS

WASHINGTON, D.C.

0 50 100 200 300 400 500 600 700 800 900 1000 FT.

CONFIDENTIAL.

- 36 SHOOTING GALLERY.
- 37 ENGINEER.
- 38 ENGR. CARPENTER SHOP.
- 39 GARAGE.
- 40 GASOLINE TANK.
- (UNDER GROUND)
- 41 COMPANY B'S SHOP.
- 42 Q.M. PAINT SHOP.
- 43 CHAPEL.
- 44 POST LAUNDRY.
- 45 PACK TRAIN ST. ROOM.
- 46 MASONRY SHOP & "
- 47 COAL BINS.
- 48 INCINERATOR.

## LEGEND.

- 1 WAR COLLEGE.
- 2 BACHELOR OFFICERS' QRS.
- 3 GATE HOUSE.
- 4 COM. & FIELD OFF. QRS.
- 5 OFFICERS' QRS.
- 6 GARAGE FOR SEARCHLIGHT TRUCKS.
- 7 INC. OFFICERS' QRS.
- 8 OFFICERS' MESS.
- 9 BARRACKS.
- 10 LITHOGRAPHIC SHOP.
- 11 MESS HALL.
- 12 ENGR. STORE HOUSE.
- 13 Q.M. STORE HOUSE.
- 14 SCALE HOUSE.
- 15 HOSPITAL.
- 16 BAND STAND.
- 17 BAND QUARTERS.
- 18 ENGINEERS' STABLES.
- 19 Q.M. & ENGR. STABLES.
- 20 Q.M. WAGON SHED.
- 21 STABLE, GUARD HOUSE.
- 22 Q.M. SHOPS.
- 23 POST BAKERY.
- 24 HOOK & LADDER SHED.
- 25 POST EXCHANGE.
- 26 GREEN HOUSES.
- 27 PONTON SHEDS.
- 28 WAR COLLEGE BOILER HO.
- 29 ENGR. PAINT SHOP.
- 30 TEAMSTERS' QRS.
- 31 DEAD HOUSE.
- 32 ENGR. WAGON SHED.
- 33 OLD TRADE SCHOOLS, PAINT SHOP, ENGR. MUSEUM, PROPERTY.
- 34 PHOTOGRAPHY.
- 35 HEADQUARTERS ENGR. SCHOOL.

